

KEYED NOTES - TECHNOLOGY PLAN

- TS1 INDICATES THE APPROXIMATE LOCATION OF THE BUILDING MDF. CONTRACTOR TO VERIFY THE LOCATION.
- TS2 INDICATES A 36X36X36-INCH CONCRETE PULL BOX AND TRANSITION POINT FOR THE AERIAL SERVICE FEED TO THE UNDERGROUND CONDUIT.
- TS3 INDICATES FOUR 4-INCH AND TWO 2-INCH CONDUITS ROUTED UNDERGROUND AND STUBBED UP INSIDE THE MDF CAPPED WITH CONCRETE AND MARKER TAPE AND INSTALLED WITH MULE TAPE PULL STRING. CONDUITS SHALL MEET THE GREATER AUSTIN AREA TELECOMMUNICATIONS NETWORK STANDARDS (GAATN). STUBBING UP AT THE POLE AT LEAST 4-INCHES AND 90-DEGREES AWAY FROM ANY OTHER UTILITY ON POLE INCLUDING GROUNDING. A 36 STRAND SINGLE MODE FIBER WILL BE INSTALLED IN EACH OF THE 4-INCH CONDUITS. THE TWO 2-INCH CONDUITS WILL BE FOR SERVICE FROM SOUTH WESTERN BELL AND TIME WARNER RESPECTIVELY. ALL GAATN WORK MUST BE COORDINATED WITH AISD TECHNOLOGY STAFF AND THE GAATN MAINTENANCE CONTRACTOR. ONLY THE GAATN MAINTENANCE CONTRACTOR MAY INSTALL AND TERMINATE GAATN FIBER OPTIC CABLE.
- TS4 INDICATES A 2-INCH CONDUIT ROUTED UNDERGROUND FROM THE MDF TO LIGHT POLE FOR SERVICE TO VIDEO SURVEILLANCE CAMERA MOUNTED AT 12 FEET A.F.F. ON LIGHT POLE. CONTRACTOR SHALL INSTALL AN OSP CATEGORY 6 CABLE FOR THE CAMERA. LIGHTNING PROTECTION IS REQUIRED FOR ALL OUTDOOR COPPER CABLE RUNS. IF DISTANCE REQUIRES, THE CATEGORY 6 CABLE WILL NEED TO BE SUBSTITUTED WITH 50 MICRON ODM FIBER OPTIC CABLE WITH MEDIA CONVERTERS. CONTRACTOR MUST VERIFY DISTANCE LIMITATIONS BEFORE INSTALLATION.
- TS5 INDICATES A 2-INCH CONDUIT ROUTED UNDERGROUND FROM THE MDF TO THE COVERED PAVILLION. CONTRACTOR SHALL INSTALL AN 12 STRAND OSP SINGLE MODE FIBER OPTIC CABLE TO SERVICE THE PAVILLION.
- TS6 INDICATES A NEW AERIAL CABLE ROUTE. SPliced AND EXTENDED FROM THE EXISTING AERIAL SERVICE ROUTE ON SPRINGDALE TO THE UNDERGROUND CONDUIT FOR SERVICE TO THE MDF. CONTRACTOR SHALL INSTALL NEW POLES ALONG THE NEW ROUTE AND PROVIDE SPLICING TO THE EXISTING AERIAL SERVICE ROUTE.
- TS7 INDICATES LIGHT POLE AND CAMERA LOCATION. CAMERA TO MOUNT AT 12 FEET A.F.F. ON POLE.
- TS9 INDICATES LOCATION FOR EXTERIOR VIDEO SURVEILLANCE CAMERA MOUNTED ON THE BUILDING AT 10 FEET A.F.F.
- TS10 INDICATES LOCATION FOR EXTERIOR WIRELESS ACCESS POINT MOUNTED ON THE BUILDING AT 10 FEET A.F.F.
- TS12 INDICATES DOOR CONTACT FOR ROOF ACCESS.
- TS13 INDICATES A NEW AERIAL CABLE ROUTE. CONTINUING FROM THE NEW UNDERGROUND CONDUIT ROUTE FROM THE MDF. THIS ROUTE WILL CONTINUE ACROSS THE STREET TO THE NEAREST EXISTING POLE FOR INTEGRATION INTO THE GAATN RING.

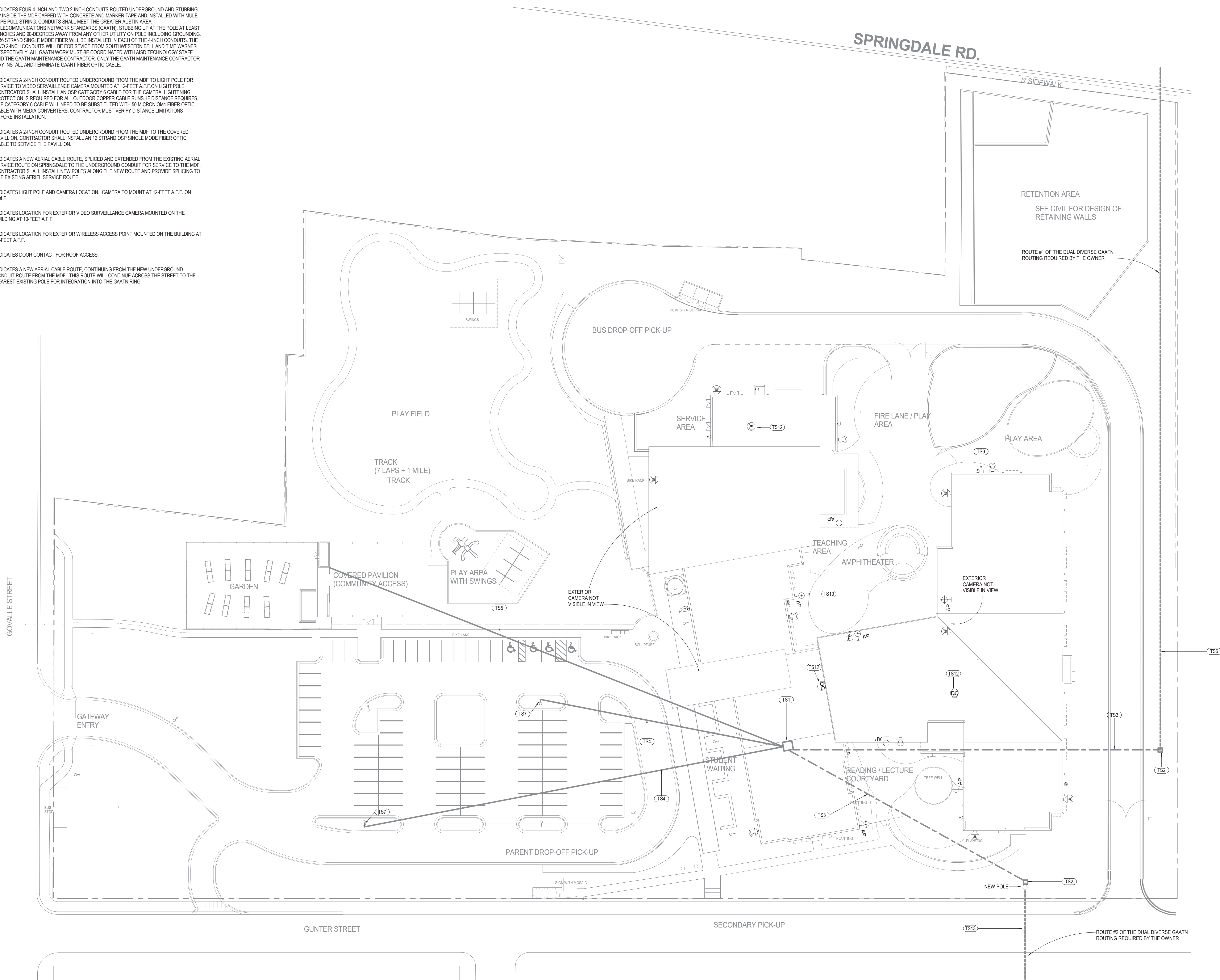

CHECKED BY: G. GRIFFIN

DRAWN BY: ANTHONY CRUZ

C:\Users\aracruz\Documents\1840 - GOVALLÉ - TECHNOLOGY - CENTRAL - R17_aeuz.rvt
10/24/2018 9:50:58 AM

ARCHITECT	AUSTIN PBK Architects, Inc.
9442 Capital of Texas Hwy, Suite 600 Austin, TX 78759 512-372-3467 F 512-372-3467 F TX FIRM: F-1808	PBK.com
ASSOCIATE ARCHITECT	SMITH & COMPANY ARCHITECTS
1100 Lakeside 500-500 Austin, TX 78701 512-281-9252 F	
CIVIL	JOSE L. GUERRA, INC.
2807 South 81st St, Suite 210 Austin, TX 78741 512-454-0000 F	
LANDSCAPE	COLLEMAN & ASSOC.
6600 Silver Mountain Drive Austin, TX 78737 512-439-7000 F	
STRUCTURAL	ENCOTECH
8500 BalHorne Cove, Suite B-103 Austin, Texas 78739 512-338-1310 F	
MEPT	ENCOTECH
8500 BalHorne Cove, Suite B-103 Austin, Texas 78739 512-338-1310 F	
FOOD SERVICE	OSPER & ASSOCIATES, INC.
13061 #3 Highway 101 San Antonio, Texas 78229 210-653-9900 F	

GOVALLÉ ELEMENTARY SCHOOL
DESIGN-BUILD
3601 Govalle Ave., Austin, TX 78702
100% ISSUE FOR PROPOSAL

AISD PROJECT No. 190004-GOVAL

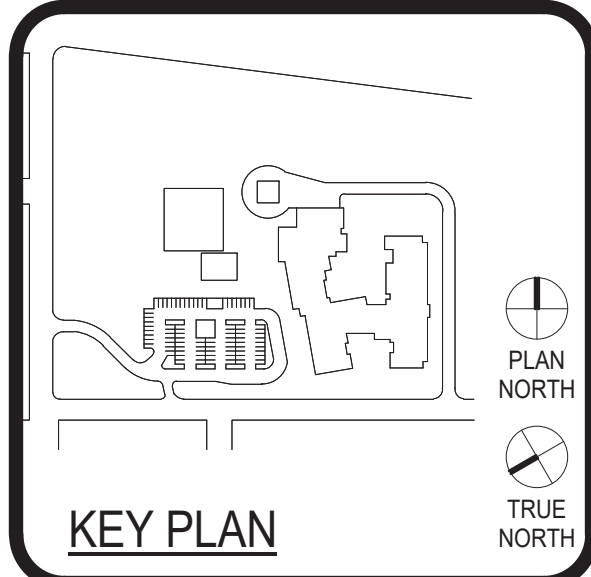

CLIENT AUSTIN INDEPENDENT SCHOOL DISTRICT		
PROJECT NUMBER 1840		
DATE 10/25/2018		
REVISIONS		
No.	Description	Date

100% ISSUE FOR PROPOSAL

TECHNOLOGY SITE PLAN

T1.01