

Educational Suitability Summary Report

Bear Creek Elementary School

Date: 12/22/2020

Score 95% Very Satisfactory

Bear Creek Elementary School, serving an enrollment of approximately 490 students in southwest Austin, is one of the first schools to be designed and built in the 2017 Bond Program. Its design follows the vision for creating 21st-century learning environment for students and educators. It was inaugurated in 2020 and the campus grounds cover approximately 19 acres. There is a lookout point off the second-level studio wing that overlooks the Hill Country and could be used as an outdoor studio. There are many open green areas. One of the playgrounds is not adjacent to the learning spaces, but it is shaded. The other playground is adjacent to a covered outdoor basketball court. There is a large cistern in the front of the campus however, no garden areas were observed.

Given its recent construction, the school meets a high percentage of the Education Specifications. The learning neighborhoods are located in a three-level structure and are connected to the administration, library, gym and cafeteria via an elongated corridor, creating an interior courtyard space. Studios are adequately sized and have built-in storage. In the learning spaces, flexible furniture allows for different size groups. There is opportunity to have breakout sessions in designated small group rooms that are adjacent to the studios. Visual connections between these rooms allows for passive supervision into these spaces. There is also ample space in the hallways allowing groups to meet outside of the studios.

The main entrance vestibule is secure and adjacent to a community room and the administration office. Visitors are unable to pass without checking in with administrators. Within the administration suite, there is a conference room at the end of the corridor for parent conferences. The acoustical quality between offices is sufficient but acoustics between the offices and hallway was of concern.

The cafeteria and gymnasium spaces are able to be accessed from the public parking and corridors leading to the gymnasium and cafeteria can be secured for after-hours activities. The cafeteria is adjacent to the gymnasium and can open into one big space for large events. The stage has a backlit projector, lighting and speakers. The furniture in the cafeteria is flexible and there is booth-type seating available. The library is just past the secure vestibule at the main entrance. There are different types of furniture allowing for small and large group study, as well as a reading area for smaller kids. Multiple windows create good transparency into the hallway.

Interview Overview

The interview was conducted with Principal David Crissey and Gene Glenn from AECOM. The principal is concerned about the capacity due to district boundary reconfigurations. If the capacity increases, Principal Crissey indicated maker spaces would have to be converted to regular studios and portables would have to be considered. The only place the campus has space for portables is in the parking lot. The campus was designed to add studios and Principal Crissey indicated that the new studio additions need to be considered.

Some other concerns centered around outdoor facilities and security. There is a lack of an open area for the students. The school backs up to a preserve, and the site is limited. There are two playground areas that are at either side of the campus. The courtyard space could be better utilized with more outdoor furniture. [REDACTED]

The hope is the facility is used to its full potential. The building is set up for collaboration for small and large groups. The idea is to foster more project-based learning. Looking ahead 20 years, Principal Crissey thinks this will become the norm. He said that technology should not follow but lead the design of the building. Another important component is furniture. Having the ability to rapidly reconfigure the spaces is essential.

Assessment Findings

The Educational Suitability Assessment of Bear Creek Elementary earned a 95% overall score and places the campus in a category of Very Satisfactory. The assessment consists of seven General Building categories and seven Academic categories to determine areas that need more attention.

Satisfactory Categories (66-80%):

Outdoor Learning and Activity

Score is satisfactory.

The outdoor playing areas are at a distance away from the studio wings. There is no direct access to play areas and no visible learning pond or garden were observed.

Technology

Score is satisfactory.

Studios do not appear have adequate number of outlets to charge devices or projectors for teaching. The cafeteria has a backlit projector and there is digital media signage in the reception office.

Very Satisfactory Categories (81-100%):

Academics & Learning

Score is very satisfactory.

Studios are sized well and have dedicated small-group breakout areas adjacent. There is excellent transparency. The school is equipped with maker spaces and locations for informal interactions.

Administrative Spaces

Score is very satisfactory.

The administrative space feels welcoming to visitors. The acoustics between offices is adequate however, sound can be heard from the hallway in the admin suite. A large conference room is available that seats 12 people.

Security

Score is very satisfactory.

[REDACTED]

**Furniture, Fixtures, Equipment**

Score is very satisfactory.

All studios and spaces have new furniture. Teachers can move furniture to offer more options of size of groups and methods of teaching. There is a variety of furniture offered in different spaces throughout the building.

Media Resources

Score is very satisfactory.

Library is easily accessible to visitors and has sufficient transparency. The library has a breakout room to support collaborative work for small groups.

General Building

Score is very satisfactory.

Main circulation routes are wide enough allowing for safe and effective movement. The layout of building provides access to gym and cafeteria for after hour functions without gaining access to the rest of school.

PE and Wellness

Score is very satisfactory.

The gym is configured well and in good condition with connected outdoor spaces. The gym has sufficient storage and connection to cafeteria for larger groups.

Exterior

Score is very satisfactory.

The circulation separates bus, vehicular and pedestrian traffic well. Trash/compost bins are accessible and directly adjacent to the kitchen area. The building is easily identifiable for visitors.

Food Services

Score is very satisfactory.

Connection to outdoor eating and plenty of seating options are available. Clean and generous kitchen space, operable partition to gym.

Visual and Performing Arts

Score is very satisfactory.

There are separate rooms for music and art. Both were well equipped with storage and amenities. Cafeteria stage is ample size for productions.

Controllability of Systems

Score is very satisfactory.

Studios have multiple dimming options for artificial lighting. Studios have their own thermostat. Exterior windows have shades to control natural lighting.

Environmental Quality

Score is very satisfactory.

02/11/2022

Educational Suitability Summary Report
Bear Creek Elementary School

Perkins&Will

The acoustics in the studios are good however, sound/voices could be heard from the hallway, likely due to the volume necessary to talk with masks on. All studios have access to natural daylight and views to the outside.

Supporting Photographs



Entry to Bear Creek is welcoming, and a covered entry is provided. The school was inaugurated in 2020.



The community room, including a prep area and restroom, is adjacent to the secured entrance lobby for easy access to the public.

Supporting Photographs



The Media Center just past the secured entrance lobby. Flexible furniture allows for different size groups.



PLC room for staff is spacious and allows for group or individual planning.

Supporting Photographs

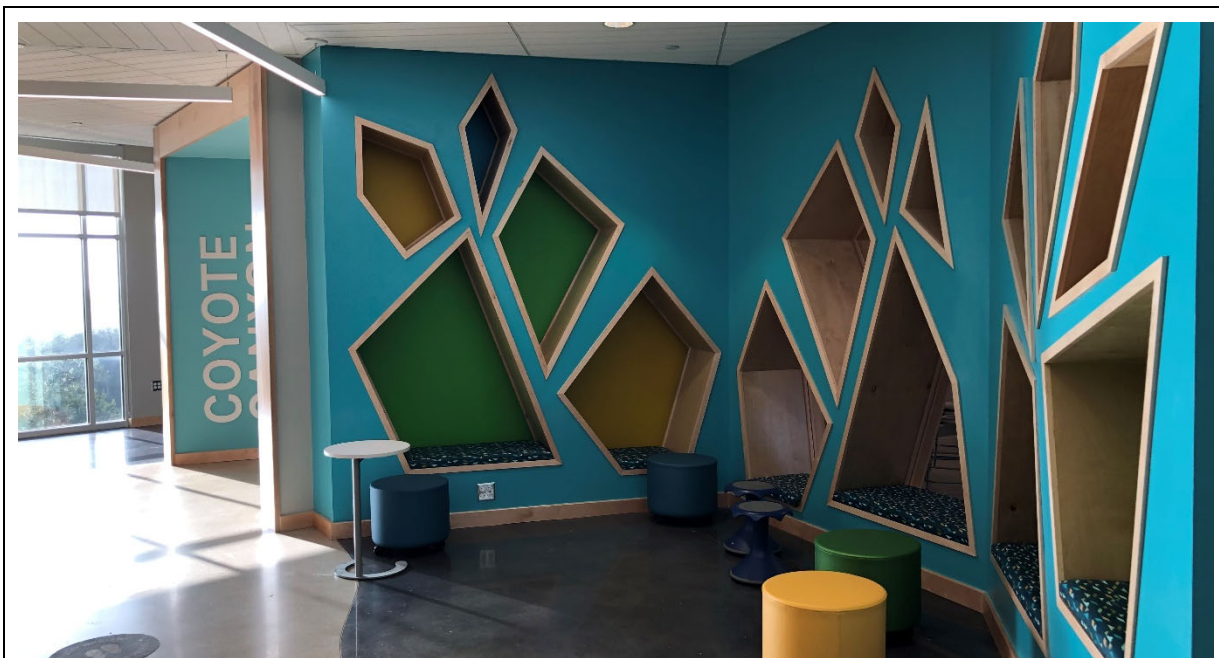

Informal meeting spaces are located throughout the learning neighborhoods of the campus.



Small group rooms are located adjacent to studios and have good transparency for passive supervision.

Supporting Photographs



The maker space has movable partitions allowing the space to open to the corridor.



Studios have flexibility to create multiple areas for different teaching methods and have good control over artificial and natural lighting.

Supporting Photographs



An outlook point connected to the studio wing allows a view of the Hill Country.



The outdoor covered basketball area is adjacent to the gym. Pre-K and kindergarten playground is beyond.



Austin ISD Educational Suitability Assessment Criteria

General Building

School Name

Bear Creek ES

Walk Attendees:

Carlos Cruz and Anacleto Rojas

Date:

12.22.2020

1 - Exterior		1	2	3	4	5	N/A	8.75	100%	
1.1	Does the site permit desirable separation of vehicular, bus and pedestrian traffic?					5		Comments	1.00	5.00
	1 Very unsatisfactory - Bus, car and pedestrian all happen at the same location							Building located far off of road and has ample room for stacking of buses and cars.		
	2 Unsatisfactory - Cars and buses mix, pedestrians are separated									
	3 Average - Buses, cars, and pedestrians are separate but stack space is small									
	4 Satisfactory - Buses, cars, and pedestrians are separate but drop off does not have a canopy or a holding place like a commons or cafeteria									
	5 Very satisfactory - Buses, cars, and pedestrians are separate and drop off area has a canopy and destination									
	N/A Does not apply									
1.2	Is the building easily identified with appropriate signage and community wayfinding?					5		Comments	0.25	1.25
	1 Very unsatisfactory - Campus has no signage / wayfinding							One main vehicular entrance with good signage, easy to navigate.		
	2 Unsatisfactory - Signage/wayfinding is faded/hidden									
	3 Average - Signage / wayfinding visible but not apparent									
	4 Satisfactory - Signage / wayfinding is visible but not good condition									
	5 Very satisfactory - Signage and wayfinding is visible and easy to use									
	N/A Does not apply									

1 - Exterior (cont.)		1	2	3	4	5	N/A		
1.3	Is the dumpster accessible for trash / compost disposal?					5		Comments	0.50 2.50
1	Very unsatisfactory - No compost present, route has obstacles (stairs, curbs, barriers) to dumpster								
2	Unsatisfactory - Compost is present. Route has obstacles to dumpster								
3	Average - Compost is present (<100' to cafeteria), Route to dumpster is free and clear but the two are not directly adjacent.								
4	Satisfactory - Compost and dumpster are directly adjacent and route is barrier free								
5	Very Satisfactory - Compost and dumpster are directly adjacent and route is barrier free. Dumpster are shaped / positioned so people of all heights can access it.								
N/A	Does not apply								
2 - Outdoor Learning and Activity		1	2	3	4	5	N/A		15.00 80%
2.1	Are outdoor studios and support spaces appropriately configured per the ed spec?			3				Comments	1.00 3.00
1	Very unsatisfactory - No dedicated outdoor studios							Outdoor studios located at distance away from the studios. There is an inner courtyard but only has landscaping and some sitting areas.	
2	Unsatisfactory - Too small, poor condition, disconnected from learning spaces, no flexibility, no shade provided								
3	Average - Adequate size, adequate condition, needs some renovations or updates to function well, 50% or less shade coverage over studio area								
4	Satisfactory - Good size, good condition, connected to learning spaces, good flexibility, more than 50% shade coverage over studio area								
5	Very satisfactory - Generous size, excellent condition, connected to learning spaces, excellent flexibility, full shade coverage over studio area								
N/A	Does not apply								
2.2	Are active playgrounds (elementary only) and support spaces configured per the ed spec?				4			Comments	1.00 4.00
1	Very unsatisfactory - No dedicated active playground								
2	Unsatisfactory - Too small, poor condition, no shade provided								
3	Average - Adequate size, adequate condition, needs some renovations or updates to function well, 50% or less shade coverage over play structure								
4	Satisfactory - Good size, good condition, more than 50% shade coverage over play structure								
5	Very satisfactory - Generous size, excellent condition, full shade coverage over play structure								
N/A	Does not apply								

2 - Outdoor Learning and Activity (cont)		1	2	3	4	5	N/A				
2.3	Are gardens and support spaces appropriately configured per the ed spec? (evaluation on infrastructure not condition of plants)	1							Comments	0.00	0.00
1	Very unsatisfactory - No dedicated gardens							Monitoring answer, does not affect score for Outdoor Learning and Activity. No gardens			
2	Unsatisfactory - Too small, poor condition, disconnected from learning spaces, no flexibility, no accessible water source										
3	Average - Adequate size, adequate condition, needs some renovations or updates to function well, water source is difficult to access										
4	Satisfactory - Good size, good condition, connected to learning spaces, good flexibility, water source is accessible with 100 ft hose										
5	Very Satisfactory - Generous size, excellent condition, connected to learning spaces, excellent flexibility, water source is less than 50ft from the garden or has irrigation										
N/A	Does not apply										
2.4	Are the rain gardens and/or cisterns appropriately configured per the ed spec?				4				Comments	0.00	0.00
1	Very unsatisfactory - No rain gardens or cisterns							Monitoring answer, does not affect score for Outdoor Learning and Activity. Significant size cistern in front of the school adjacent to the cafeteria area.			
2	Unsatisfactory - Too small, poor condition, not functioning, disconnected										
3	Average - Adequate size, adequate condition, is connected, needs some renovations or updates to function well										
4	Satisfactory - Good size, good condition, functions properly										
5	Very Satisfactory - Generous size, excellent condition, exceptional functionality, connected to learning spaces, educational signage provided										
N/A	Does not apply										
2.5	Does the school have animal husbandry? (optional)	1							Comments	0.00	0.00
1	No										
5	Yes										
2.6	Does the school have nature loop trails? (optional)	1							Comments	0.00	0.00
1	No										
5	Yes										
2.7	Does the school have a learning pond? (optional)	1							Comments	0.00	0.00
1	No										
5	Yes										
2.8	Does the school have a grass play field and walking trail?					5			Comments	1.00	5.00
1	No										
5	Yes										

3 - General Building		1	2	3	4	5	N/A	11.25	100%	
3.1	Are interior circulation routes wide enough to safely and effectively accommodate student movement?					5		Comments	0.50 2.50	
	1 Very unsatisfactory - Primary circulation is 5'-0" to 6'-0" wide							12 feet in main corridors.		
	2 Unsatisfactory - Primary circulation is 6'-0" to 7'-0" wide									
	3 Average - Primary circulation is 7'-0" to 8'-0" wide									
	4 Satisfactory - Primary circulation is 8'-0"-10'-0" wide									
	5 Very satisfactory - Primary circulation is 10'-0"+ wide									
	N/A Does not apply									
3.2	Are community use areas arranged so that the school can allow night functions without full school access?					5		Comments	0.75 3.75	
	1 Very unsatisfactory - Cafeteria, gym, and library cannot be accessed after hours							Yes. Entrance from parking lot to gym area can be closed off to rest of campus.		
	2 Unsatisfactory - Only one of the public spaces (Cafeteria, Gym and Library) can be accessed from parking and secured after hours									
	3 Average - Only two of the public spaces can be accessed from parking and secured after hours									
	4 Satisfactory - All of the public spaces can be accessed from parking and secured from the rest of the building but not individually									
	5 Very satisfactory - Cafeteria, gym, and library can be accessed from parking and locked off from rest of campus for night/evening use with their own entrance									
	N/A Does not apply									
3.3	Is there a community room that is a dedicated meeting space outside of school function?					5		Comments	0.75 3.75	
	1 Very unsatisfactory - No dedicated community room							Off of secured vestibule. Ample size for a good size group.		
	2 Unsatisfactory - Community room but within school function, no access after school hours									
	3 Average - Community room, moderate size, but need some renovations or updates to function well									
	4 Satisfactory - Community room, good size /layout, meets needs /functions well									
	5 Very Satisfactory - Community room, generous size, nice condition, functions appropriately outside of school function									
	N/A Does not apply									
3.4	Does the general appearance of the school convey pride for the students and community?					5		Comments	0.25 1.25	
	1 Very unsatisfactory - General appearance is poor							New school dedicated this year.		
	2 Unsatisfactory - General appearance is aged but ok									
	3 Average - General appearance is good									
	4 Satisfactory - General appearance shows pride in campus and student works									
	5 Very Satisfactory - General appearance shows pride in campus and student works and is welcoming to the community									
	N/A Does not apply									

4 - Security		1	2	3	4	5	N/A	16.25	
4.1	Does the facility have key card access at all major entries?							0.25	
1	Very unsatisfactory - No entries								
2	Unsatisfactory - 1/4 of major entries								
3	Average - 1/2 of major entries								
4	Satisfactory - 3/4 of major entries								
5	Very satisfactory - All of major entries								
N/A	Does not apply								
4.2	How adequate is site lighting and security for the campus overall?							1.00	
1	Very unsatisfactory - No exterior lighting, no secure perimeter								
2	Unsatisfactory - Lighting is limited to front entry only, parking lot lighting poor, security is minimal								
3	Average - Lighting at all night-use entries and parking lot, but poor condition. Security is moderate								
4	Satisfactory - Lighting at all night-use entries and parking lots, good condition, signage less visible, perimeter is well secured but needs updates								
5	Very satisfactory - Signage, parking lots, and entries are well lit, visible and easy to use, perimeter is very secure								
N/A	Does not apply								
4.3	Is the main office located at the school entry and configured with a secure vestibule to the main corridor?							1.00	
1	Very unsatisfactory - No secure vestibule, office located far from main entry, allows visitors access to school unsupervised								
2	Unsatisfactory - No secure vestibule, office located somewhat far from main entry, minimal supervision of visitors								
3	Average - Office close to entry, views of front door, but no secure vestibule								
4	Satisfactory - Office is well-located with a secure vestibule, but needs updates								
5	Very satisfactory - Office well-located with secure vestibule and all appropriate security features								
N/A	Does not apply								
4.4	Is there enough interior transparency for faculty to passively supervise learners and their activities who are not in studios?					5		1.00	5.00
1	Very unsatisfactory - No transparency of walls								
2	Unsatisfactory - Limited transparency in certain locations								
3	Average - Good transparency in certain locations but inadequate or missing in other locations of school								
4	Satisfactory - Adequate transparency throughout the school								
5	Very satisfactory - Excellent transparency throughout the school								
N/A	Does not apply								

There is good transparency for the breakout smaller rooms adjacent to the studios allowing the instructor to see in those rooms from the studios.

5 - Environmental Quality		1	2	3	4	5	N/A	25.00	100%	
5.1	How are acoustics in studios in general?					5		Comments	1.00 5.00	
1	Very unsatisfactory - Recognized word/sound from adjacent studio/corridor							Conversation can be heard from corridor, likely due to volume needed with masks.		
2	Unsatisfactory - Audible sound from adjacent studio/corridor									
3	Average - Slight sound from outside room									
4	Satisfactory - Walls to deck insulated only white noise from mechanical system									
5	Very satisfactory - Able to hear quiet speaking from across the room									
N/A	Does not apply									
5.2	Is the studio artificial lighting adequate quality?					5		Comments	1.00 5.00	
1	Very unsatisfactory - Sporadic lights work, glare, less than 20 FC									
2	Unsatisfactory - 10-19 FC or serious glare									
3	Average- 20-29 FC minor glare									
4	Satisfactory - 30-39 FC and no glare									
5	Very satisfactory - 40+ FC and no glare									
N/A	Does not apply									
5.3	Is there access to natural light in studios?					5		Comments	1.00 5.00	
1	Very unsatisfactory - No learning spaces have natural light							All studios have access to natural light		
2	Unsatisfactory - 1-25% of learning spaces have natural light or windows are too small to let in light									
3	Average - 26-50% of learning spaces have natural light									
4	Satisfactory - 51-75% of learning spaces have natural light									
5	Very satisfactory - 76-100% of learning spaces have natural light									
N/A	Does not apply									
5.4	Is there access to outside views from learning spaces?					5		Comments	1.00 5.00	
1	Very unsatisfactory - No learning spaces have views							All studios have access to outside views		
2	Unsatisfactory - 1-25% of learning spaces have views or windows are too small to see out									
3	Average - 26-50% of learning spaces have views									
4	Satisfactory - 51-75% of learning spaces have views									
5	Very satisfactory - 76-100% of learning spaces have views									
N/A	Does not apply									

5 - Environmental Quality (cont.)		1	2	3	4	5	N/A		
5.5	Does the building have odor or pest problems?					5		Comments	1.00 5.00
1	Very unsatisfactory - Evidence of both pests and odors								
2	Unsatisfactory - Evidence of pests or odors								
3	Average - Limited evidence of pests, no odors								
4	Satisfactory - No evidence of pests / odors, school cleanliness in good condition								
5	Very Satisfactory - No evidence, school cleanliness in excellent condition								
N/A	Does not apply								
6 - Controllability of Systems		1	2	3	4	5	N/A		12.50 100%
6.1	Does the studio thermostat allow for individual control?					5		Comments	0.50 2.50
1	No								
5	Yes								
6.2	Are shades provided to control natural light in learning spaces?					5		Comments	1.00 5.00
1	Very unsatisfactory - No, windows are covered with boards/paper								
2	Unsatisfactory - No, windows have no light control								
3	Average - Yes, but poor condition blinds								
4	Satisfactory - Yes, blinds								
5	Very satisfactory - Blackout shades								
N/A	Does not apply								
6.3	What is the quality of lighting controls in the studios?					5		Comments	1.00 5.00
1	Very unsatisfactory - Single switch only per room								Multiple dimming capabilities.
2	Unsatisfactory - Alternating rows switch off								
3	Average - Alternating lamps in single fixtures switch off								
4	Satisfactory - Tri level switching								
5	Very satisfactory - Dimmable								
N/A	Does not apply								

7 - Furniture, Fixtures & Equipment		1	2	3	4	5	N/A	18.75	100%	
7.1	What is the current condition of the furniture?					5		Comments	0.75 3.75	
1	Very unsatisfactory - Damaged or broken, non-functioning									
2	Unsatisfactory - Torn/ bent/ wrong size									
3	Average - Scratched/dented/marked									
4	Satisfactory - Not new, but sturdy and clean									
5	Very satisfactory - New									
N/A	Does not apply									
7.2	Are a variety of furniture types being accommodated throughout the school - learning commons, dining commons, other multi-use spaces?					5		Comments	1.00 5.00	
1	Very Unsatisfactory - Same furniture used in all spaces									
2	Unsatisfactory - Furniture variety in one multi-use space									
3	Average - Furniture variety in more than one multi-use space									
4	Satisfactory - All multi-use spaces have greater than one type of furniture									
5	Very satisfactory - All multi-use spaces have greater than two types of furniture									
N/A	Does not apply									
7.3	How well does furniture accommodate rapid reconfiguration of a space?					5		Comments	1.00 5.00	
1	Very Unsatisfactory - Furniture is fixed or very heavy								Larger group tables are harder to move, depends on grade level.	
2	Unsatisfactory - Furniture does not allow desks to be configured as individuals, small groups, or large groups									
3	Average - Mix of furniture that can reconfigure but is cumbersome to move									
4	Satisfactory - Furniture is flexible for multiple configurations of space									
5	Very satisfactory - Furniture is flexible for multiple configurations of space, easy to move and stack									
N/A	Does not apply									
7.4	Is the furniture ergonomic and size appropriate for grade level?					5		Comments	1.00 5.00	
1	Very unsatisfactory - Desk with attached chair combinations too small for grade level								Combo of desk or tables, depending on grade level.	
2	Unsatisfactory - Desk with attached chair combinations									
3	Average - Mix of studios with tables/loose chairs and desks with fixed seats									
4	Very satisfactory - Tables with loose chairs									
5	Very satisfactory - Tables with loose chairs that allow students to be active									
N/A	Does not apply									

Zero Waste		1	2	3	4	5	N/A	5.00	100%	
Do studios and corridors have blue recycle bins with bilingual instructions and/or image sorting instructions?						5		0.50	2.50	
1	Very unsatisfactory - There are no recycling and landfill bins and signage are sparse or infrequent, OR there are only landfill bins with no recycling bins.	<p>A score for this category is being recorded, but this category is not calculated in the overall ESA average.</p> <p>No clear signage.</p>								
2	Unsatisfactory - Bins and signage are sparse or infrequent and/or lack clear signage.									
3	Average - 50% of corridors and studios have both a landfill bin and a recycle bin in an accessible location. The containers have clear signage.									
4	Satisfactory - 75% of studios and corridors have a visible landfill and recycle collection containers in an accessible location. The containers have clear signage.									
5	Very satisfactory - All studios / corridors (100%) have visible landfill and recycle collection containers in accessible locations. The containers have clear signage, and the style and format is consistent and uniform across campus.									
N/A	Does not apply									
Does the cafeteria (or wherever meals are served) have at least one of each: green compost bin, blue recycle bin, and landfill bin? Are the bins labelled clearly with bilingual and/or image sorting?						5		0.50	2.50	
1	Very unsatisfactory- There may be landfill bins, but there are no compost and/or recycle bins. There is not clear sorting signage.	<p>No labeled bins.</p>								
2	Unsatisfactory- Recycle, landfill, and compost bins are present, but the bins are scattered and no co-located next to one another. Signage is absent or inconsistent.									
3	Average- There is at least one waste station with all three bins (recycle, compost, landfill) located with close proximity to one another. The signage is visible and consistent.									
4	Satisfactory- There are several waste stations as described above									
5	Very Satisfactory - There are several waste stations as described above, and additional signage in the cafeteria that encourages recycling/composting.									
N/A	Does not apply									



Austin ISD Educational Suitability Assessment Criteria

Academics - Elementary School

School Name

Bear Creek ES

Walk Attendees:

Carlos Cruz and Anacleto Rojas

Date:

12.22.20

8 - Academics & Learning		1	2	3	4	5	N/A	70.00	99%	
8.1	Are studios appropriately configured per the ed spec?					5		Comments	1.00 5.00	
1	Very unsatisfactory - Too small, no flexibility, disconnected	Studios meet the configuration of the ed spec in terms of program layout. The studio spaces average below the 800 NSF. The studios tend to be around 775 NSF. The small group (5) tend to be around 115 NSF. Ed spec indicates NSF of 125.								
2	Unsatisfactory - Too small, only one area for all teaching methods, limited flexibility, disconnected									
3	Neutral - Adequate size, multiple areas for different teaching methods, adequate flexibility, limited transparency and connection to other studios and shared learning spaces, needs updates or renovations to function well.									
4	Satisfactory - Good size, multiple areas for different teaching methods, good flexibility, good transparency and connection to other studios and shared learning spaces									
5	Very Satisfactory - Generous size, multiple areas for different teaching methods, excellent flexibility, generous display area and visual teaching tools, excellent transparency and connection with other studios and shared learning spaces									
N/A	Does not apply									
8.2	Do Pre-K and Kinder have appropriate support spaces such as restrooms and storage per the ed spec?					5		Comments	1.00 5.00	
1	Very unsatisfactory - None provided									
2	Unsatisfactory - Too small, disconnected, poor condition									
3	Neutral - Adequate size, average condition, needs updates or renovations to function well									
4	Satisfactory - Good size, connected, good condition									
5	Very Satisfactory - Generous size, connected, excellent condition									
N/A	Does not apply									

8 - Academics & Learning (cont.)		1	2	3	4	5	N/A		
8.3	Do studios have appropriate support spaces such as storage per the ed spec?				4			Comments	1.00 4.00
	1 Very unsatisfactory - None provided 2 Unsatisfactory - Too small, disconnected, poor condition 3 Neutral - Adequate size, average condition, needs updates or renovations to function well 4 Satisfactory - Good size, connected, good condition 5 Very Satisfactory - Generous size, connected, excellent condition N/A Does not apply	Storage provided in casework.							
8.4	Do typical learning neighborhoods have small group rooms and open collaboration space?					5		Comments	1.00 5.00
	1 Very unsatisfactory - No breakout rooms or open collaboration spaces are provided 2 Unsatisfactory - Too small or too few, poor condition, no flexibility, lacks visual connection to learning neighborhood, poor acoustic privacy 3 Average - Adequate size, adequate condition, needs some renovations or updates to function well 4 Satisfactory - Good size, good condition and flexibility, transparency and connection to learning neighborhood, acoustic privacy 5 Very Satisfactory - Generous size, excellent condition and flexibility, transparency and connection to learning neighborhood, acoustic privacy N/A Does not apply	Small flex space in corridors of learning neighborhood, and dedicated small-group rooms in most areas. Visibility to breakout spaces is excellent.							
8.5	Are general studios large enough to support project-based learning and multiple teaching modalities?					5		Comments	1.00 5.00
	1 Very unsatisfactory - Too small, no flexibility, does not support project-based learning 2 Unsatisfactory - Undersized, decentralized resources, limited flexibility 3 Average - Adequate size, needs some renovations or updates to function well 4 Satisfactory - Good size, centralized resources, good flexibility 5 Very Satisfactory - Generous size, centralized project resources, excellent flexibility N/A Does not apply	Flexible furniture allows for better flexibility.							

8 - Academics & Learning (cont.)		1	2	3	4	5	N/A			
8.6	Are Maker Spaces and support spaces appropriately configured per the ed spec?					5		Comments	1.00 5.00	
1	Very unsatisfactory - No dedicated maker spaces							Maker space currently not set up due to COVID but dedicated space is provided.		
2	Unsatisfactory - Too small, poor condition, disconnected from learning spaces, no flexibility									
3	Average - Adequate size, adequate condition, needs some renovations or updates to function well									
4	Satisfactory - Good size, good condition, connected to learning spaces									
5	Very Satisfactory - Generous size, excellent condition, connected to learning spaces									
N/A	Does not apply									
8.7	Is there a Professional Learning Center in the learning neighborhood?					5		Comments	1.00 5.00	
1	Very unsatisfactory - No dedicated space for Professional Learning Center									
2	Unsatisfactory - Too small, poor condition, disconnected									
3	Average - Adequate size, adequate condition, needs some renovations or updates to function well									
4	Satisfactory - Good size, good condition, connected									
5	Very Satisfactory - Generous size, excellent condition, connected									
N/A	Does not apply									
8.8	Is there a dedicated science room and support space?	1						Comments	0.00 0.00	
1	No							Monitoring answer, but doesn't affect overall score.		
5	Yes									
8.9	Are there adequate places to display the evidence and artifacts of learning (both 2D and 3D)?					5		Comments	1.00 5.00	
1	Very unsatisfactory - No dedicated space							Large display at secure vestibule and tack strips for 2D display throughout corridors.		
2	Unsatisfactory - Too small, non-dedicated, poor condition									
3	Average - Adequate size, adequate condition, needs updates or renovations to function well									
4	Satisfactory - Good size, good condition									
5	Very Satisfactory - Generous size, excellent condition									
N/A	Does not apply									

8 - Academics & Learning (cont.)		1	2	3	4	5	N/A			
8.10	Does the building provide adequate opportunities for students/teachers to collaborate in varying group sizes?					5		Comments	1.00 5.00	
1	Very unsatisfactory - No space to support collaboration in various sizes.							Dedicated small-group rooms, plenty of larger gathering spaces.		
2	Unsatisfactory - Too small, inflexible, only one option, does not support a variety of group sizes									
3	Average - Adequate space for collaboration, needs updates or renovations to function well.									
4	Satisfactory - Good size, good condition, multiple options to support a variety of group sizes									
5	Very Satisfactory - Generous size, excellent condition, multiple options to support a variety of group sizes									
N/A	Does not apply									
8.11	Does the building provide opportunities for informal interaction?					5		Comments	1.00 5.00	
1	Very unsatisfactory - No space							Informal furnishings provide more opportunities and are in ample space for this to occur.		
2	Unsatisfactory - Too small, poor condition, layout and furnishings do not support informal interaction well									
3	Average - Adequate size and condition, needs updates or renovations to function well.									
4	Satisfactory - Good size, good condition, layout and furnishings support informal interactions									
5	Very Satisfactory - Generous size, excellent condition, layout and furnishings support informal interactions									
N/A	Does not apply									
8.12	Does the learning neighborhood / building provide adequate opportunities for students to work independently?					5		Comments	1.00 5.00	
1	Very unsatisfactory - No breakout rooms/small study spaces							There are opportunities in the hallways and small-group rooms.		
2	Unsatisfactory - Too small, poor condition, no acoustic privacy, only one space for independent work, disconnected from learning neighborhood									
3	Average - Adequate size and condition, needs updates or renovations to function well.									
4	Satisfactory - Good size and condition, acoustic privacy, variety of independent work space options, connected to learning neighborhood									
5	Very Satisfactory - Generous size, excellent condition, acoustic privacy, variety of independent work space options, connected to learning neighborhood									
N/A	Does not apply									

8 - Academics & Learning (cont.)											
8.13	Are Special Education spaces appropriately configured per the ed spec?					5		Comments	1.00	5.00	
1	Very unsatisfactory - Too small, no flexibility, disconnected										
2	Unsatisfactory - Too small, only one area for all teaching methods, limited flexibility, disconnected										
3	Neutral - Adequate size, multiple areas for different teaching methods, adequate flexibility, limited transparency and connection to other studios and shared learning spaces, needs updates or renovations to function well.										
4	Satisfactory - Good size, multiple areas for different teaching methods, good flexibility, good transparency and connection to other studios and shared learning spaces										
5	Very Satisfactory - Generous size, multiple areas for different teaching methods, excellent flexibility, generous display area and visual teaching tools, excellent transparency and connection with other studios and shared learning spaces										
N/A	Does not apply										
8.14	Are Special Education support spaces, such as storage, space for washer/dryer, appropriately configured per the ed spec?					5		Comments	1.00	5.00	
1	Very unsatisfactory - None provided							Life skills room large and open. Have separate PT/OT/speech rooms.			
2	Unsatisfactory - Too small, disconnected, poor condition										
3	Neutral - Adequate size, average condition, needs updates or renovations to function well										
4	Satisfactory - Good size, connected, good condition										
5	Very Satisfactory - Generous size, connected, excellent condition										
N/A	Does not apply										
8.15	Are Accessible restrooms and changing rooms readily available to the Special Education spaces?					5		Comments	1.00	5.00	
1	No										
5	Yes										

9 - Visual and Performing Arts		1	2	3	4	5	N/A	15.00	100%	
9.1	Are music spaces and the cafeteria stage appropriately configured per the ed spec?					5		Comments	1.00 5.00	
	1 Very unsatisfactory - Too small, missing program spaces									
	2 Unsatisfactory - Too small, poor condition									
	3 Neutral - Adequate size, adequate condition, needs updates or renovations to function well.									
	4 Satisfactory - Good size, good condition									
	5 Very Satisfactory - Generous size, excellent condition									
	N/A Does not apply									
9.2	Are music and performance storage spaces appropriately configured per the ed spec?					5		Comments	1.00 5.00	
	1 Very unsatisfactory - None provided									
	2 Unsatisfactory - Too small, disconnected, poor condition									
	3 Neutral - Adequate size, average condition, needs updates or renovations to function well									
	4 Satisfactory - Good size, connected, good condition									
	5 Very Satisfactory - Generous size, connected, excellent condition									
	N/A Does not apply									
9.3	Are Visual Arts spaces and storage appropriately configured per the ed spec?					5		Comments	1.00 5.00	
	1 Very unsatisfactory - Too small, missing program spaces									
	2 Unsatisfactory - Too small, poor condition									
	3 Average - Adequate size, adequate condition, needs some renovations or updates to function well									
	4 Satisfactory - Good size, good condition									
	5 Very Satisfactory - Generous size, excellent condition									
	N/A Does not apply									
									Kiln, abundant storage and movable desks.	

10 - PE and Wellness		1	2	3	4	5	N/A	10.00	100%	
10.1	Does the campus meet the ed spec standard for physical education program spaces?					5		Comments	1.00 5.00	
	1 Very unsatisfactory - Too small, missing program spaces									
	2 Unsatisfactory - Too small, poor condition									
	3 Average - Adequate size, adequate condition, needs some renovations or updates to function well									
	4 Satisfactory - Good size, good condition									
	5 Very Satisfactory - Generous size, excellent condition									
	N/A Does not apply									
10.2	Are the physical education storage spaces appropriately configured per the ed spec?					5		Comments	1.00 5.00	
	1 Very unsatisfactory - None provided								Double doors to exterior connected to outdoor play and outdoor basketball court.	
	2 Unsatisfactory - Too small, disconnected, poor condition									
	3 Neutral - Adequate size, average condition, needs updates or renovations to function well									
	4 Satisfactory - Good size, connected, good condition									
	5 Very Satisfactory - Generous size, connected, excellent condition									
	N/A Does not apply									
11 - Food Services		1	2	3	4	5	N/A	10.00	100%	
11.1	Is the Dining Commons appropriately configured per the ed spec?					5		Comments	1.00 5.00	
	1 Very unsatisfactory - Too small, missing program spaces								Connection to outdoor eating and plenty of seating options are available. Clean and generous kitchen space, operable partition to gym.	
	2 Unsatisfactory - Too small, poor condition, only one option for eating space provided, inadequate circulation									
	3 Average - Adequate size and condition, needs updates or renovations to function well									
	4 Satisfactory - Good size and condition, good circulation, multiple options for eating space (ex: connection to outdoor eating space)									
	5 Very Satisfactory - Generous size, excellent condition and circulation, multiple options for eating space (ex: connection to outdoor eating space)									
	N/A Does not apply									
11.2	Are the Food Services support spaces appropriately configured per the ed spec?					5		Comments	1.00 5.00	
	1 Very unsatisfactory - None provided									
	2 Unsatisfactory - Too small, disconnected, poor condition									
	3 Neutral - Adequate size, average condition, needs updates or renovations to function well									
	4 Satisfactory - Good size, connected, good condition									
	5 Very Satisfactory - Generous size, connected, excellent condition									
	N/A Does not apply									

12 - Media Resources		1	2	3	4	5	N/A	30.00	87%
12.1	Is the Library/Media Center easily accessible for the occupants and visitors to the school?				4			Comments	1.00 4.00
	1 Very unsatisfactory - Not accessible 2 Unsatisfactory - Limited access, difficult to find, no transparency 3 Average - Adequate accessibility, needs updates or renovations to function well 4 Satisfactory - Accessible, easy to find, good transparency, good condition 5 Very Satisfactory - Accessible, easy to find, excellent transparency, excellent condition N/A Does not apply	Easy to find and located near entry just off of secured vestibule.							
12.2	How well does the Library/Media Center support quiet study?		2					Comments	1.00 2.00
	1 Very unsatisfactory - No quiet study spaces 2 Unsatisfactory - One area in poor condition, poor acoustic privacy 3 Average - One or more areas provided, needing updates or renovations to function well 4 Satisfactory - Clusters or small rooms adjacent to media center, good condition, good acoustic privacy 5 Very Satisfactory - Multiple clusters or small rooms adjacent to media center, excellent condition, excellent acoustic privacy N/A Does not apply	1 space. No small group room or quiet study space.							
12.3	How well does the Library/Media Center support social interaction?					5		Comments	1.00 5.00
	1 Very unsatisfactory - No space 2 Unsatisfactory - Too small, poor condition, layout and furnishings do not support informal interaction well 3 Average - Adequate size and condition, needs updates or renovations to function well. 4 Satisfactory - Good size, good condition, layout and furnishings support informal interactions 5 Very Satisfactory - Generous size, excellent condition, layout and furnishings support informal interactions N/A Does not apply								
12.4	How well does the Library/Media Center support collaborative work in small groups (4-8 students)?					5		Comments	1.00 5.00
	1 Very unsatisfactory - No breakout rooms, no flexible furniture, no support 2 Unsatisfactory - Too small, one area, poor condition 3 Average - Adequate size, multiple areas provided, needing updates or renovations to function well 4 Satisfactory - Clusters or small rooms adjacent to media center, flexible furniture, good condition 5 Very Satisfactory - Multiple clusters or small rooms adjacent to media center, flexible furniture, excellent condition N/A Does not apply	Small area can be set up with different furniture grouping but no separate room.							

12 - Media Resources - Continued		1	2	3	4	5	N/A			
12.5	How well does the Library/Media Center support collaborative work in larger groups (10-25)?					5		Comments	1.00 5.00	
1	Very unsatisfactory - No gathering areas									
2	Unsatisfactory - Too small, one common space, limited seating, poor condition									
3	Average - Adequate size, one common space, needs updates or renovations to function well									
4	Satisfactory - Good size, multiple common spaces with seating, good condition									
5	Very Satisfactory - Generous size, multiple commons spaces with seating, excellent condition									
N/A	Does not apply									
12.6	How well does the Library/Media Center support technology?					5		Comments	1.00 5.00	
1	Very unsatisfactory - No vis comm tools							Projection		
2	Unsatisfactory - Outdated, poorly functioning, or insufficient									
3	Good - Mix of old and new whiteboards/projectors/etc.									
4	Satisfactory - Projectors, marker boards, smart boards in most spaces - good condition									
5	Very Satisfactory - Projectors, marker boards, smart boards in most spaces - new condition									
N/A	Does not apply									
13 - Technology		1	2	3	4	5	N/A	20.00 75%		
13.1	How well equipped are the facilities with instructional technology?			3				Comments	1.00 3.00	
1	Very unsatisfactory - Limited to no technology present in instructional spaces							No projectors		
2	Unsatisfactory - One type of technology present									
3	Average - Multiple types of technology, smart boards, poor condition, limited to only certain areas of school									
4	Satisfactory - Multiple types of technology, smart boards, good condition.									
5	Very Satisfactory - Multiple types of technology, smart boards, excellent condition									
N/A	Does not apply									
13.2	Is there an adequate number of power and data outlets in learning spaces?				4			Comments	1.00 4.00	
1	Very unsatisfactory - Outlet configuration does not support digital devices throughout school (1 per wall)									
2	Unsatisfactory - Outlet configuration support digital devices only in certain areas of school (2 per wall)									
3	Average - Outlet configuration support digital devices but not enough capacity throughout school (3 per wall)									
4	Satisfactory - Outlet configuration support digital devices with adequate coverage and capacity throughout school (>3 per wall)									
5	Very Satisfactory - Excellent outlet configuration to support digital devices throughout school (>3 per wall)									
N/A	Does not apply									

13 - Technology (cont.)		1	2	3	4	5	N/A				
13.3	Are there adequate charging locations for devices?			3				Comments	1.00	3.00	
1	Very unsatisfactory - No centralized charging location							Studios do not have adequate number of outlets to charge devices.			
2	Unsatisfactory - Centralized charging location, but inadequate in size for number of devices										
3	Average - Charging cart or tower but not adequately sized for number of devices										
4	Satisfactory - Charging cart or tower not centralized										
5	Very Satisfactory - Charging cart or tower located centralized location. Excellent condition										
N/A	Does not apply										
13.4	Is there adequate AV for presentations spaces – cafeteria and gym?					5		Comments	1.00	5.00	
1	Very unsatisfactory - AV not present in one or more space							Backlit projector screen.			
2	Unsatisfactory - AV undersized for room, poor condition										
3	Average - Adequately sized / poor condition OR AV undersized / adequate condition										
4	Satisfactory - Good size, good condition										
5	Very Satisfactory - Generous sized, excellent condition										
N/A	Does not apply										
13.5	Is there digital media signage at the reception area?					5		Comments	0.00	0.00	
1	Very unsatisfactory - No digital media present in reception area										
2	Unsatisfactory - Undersized, poor condition										
3	Average - Adequately sized / poor condition OR undersized / adequate condition										
4	Satisfactory - Media signage present, good sized, good condition										
5	Very Satisfactory - Generously sized, excellent condition										
N/A	Does not apply										

